

HIGHLAND PLAYGROUND IMPROVEMENTS  
HIGHLAND ELEMENTARY SCHOOL  
2625 JEFFERSON ST OMAHA, NE 68107

GENERAL NOTES - SITE:

- ALL GRASSED AREAS DISTURBED SHALL BE RESTORED BACK TO TURF GRASS. ALL PAVEMENT SURFACES DISTURBED SHALL BE REPAVED TO MATCH EXISTING THICKNESS AND JOINTING.
- ALL CONSTRUCTION SHALL BE IN ACCORDANCE WITH THE MOST CURRENT CITY OF OMAHA STANDARD DRAWINGS AND SPECIFICATIONS, UNLESS OTHERWISE NOTED.
- CONTRACTOR SHALL REVIEW CONTRACT REQUIREMENTS AND PROCEDURES OUTLINED IN THE SPECIFICATIONS. THE WORK OUTLINED IN THE DRAWINGS AND SPECIFICATIONS SHALL BE INCORPORATED INTO THE THE GENERAL CONTRACT. THE GENERAL CONTRACTOR SHALL BE RESPONSIBLE FOR ALL MATERIALS, METHODS, AND MEANS REQUIRED TO EXECUTE THE GENERAL CONTRACT AND PROVIDE A FINISHED PRODUCT.
- IT IS THE INTENT OF THIS CONTRACT THAT ALL AREAS AFFECTED BY CONSTRUCTION BE A FINISHED AND COMPLETE PRODUCT. THEREFORE, CONTRACTOR SHALL PATCH, REPAIR, AND ADJUST AS REQUIRED TO ACHIEVE THIS FINISHED PRODUCT. CONTRACTOR SHALL PATCH AND REPAIR ALL EXISTING WORK AFFECTED OR DAMAGED BY DEMOLITION TO MATCH NEW CONSTRUCTION.
- LOCATE AND FLAG ALL UNDERGROUND PRIVATE AND PUBLIC UTILITIES PRIOR TO ANY CONSTRUCTION. ANY DAMAGE TO UTILITIES OR OTHER SITE IMPROVEMENTS CAUSED BY CONTRACTOR WILL BE REPAIRED AT NO COST TO THE OWNER.
- THE APPROXIMATE LOCATIONS OF KNOWN UTILITY MAINS AND SERVICE LINES (I.E. GAS, CABLE TV, TELEPHONE, POWER, WATER, SEWER) HAVE BEEN INDICATED ON THE OWNER PROVIDED DRAWINGS. HOWEVER, THE EXACT LOCATION MAY VARY FROM THE APPROXIMATE INDICATED LOCATIONS. THEREFORE, THE CONTRACTOR SHALL VERIFY THE EXACT LOCATIONS AND DEPTHS OF EACH UTILITY WITH THE APPROPRIATE UTILITY COMPANY PRIOR TO START OF CONSTRUCTION.
- THE CONTRACTOR SHALL HIRE AND PAY FOR A PRIVATE UTILITY LOCATOR TO PROVIDE LOCATES FOR ALL PRIVATE UTILITIES NOT IDENTIFIED BY THE UTILITY COMPANIES.
- THE CONTRACTOR SHALL BE SOLELY RESPONSIBLE FOR SECURING ALL EQUIPMENT OR MATERIALS TO REMAIN STORED ON SITE THROUGHOUT THE CONSTRUCTION PROCESS. THE OWNER IS NOT RESPONSIBLE FOR LOST, STOLEN, OR DAMAGED EQUIPMENT OR STORED MATERIALS LEFT ON SITE BY THE CONTRACTOR.
- THE CONTRACTOR IS RESPONSIBLE FOR ALL PROJECT SAFETY. STUDENTS AND FACULTY MAY BE PRESENT ON CAMPUS AT TIME OF PROJECT.
- CONTRACTOR SHALL CONTAIN ALL STAGING, STOCKPILING, AND VEHICLE MOVEMENTS WITHIN THE LIMITS DETERMINED BY OWNER PRIOR TO MOBILIZING ON SITE.
- THERE SHALL BE NO SMOKING OR USE OF ANY TOBACCO PRODUCTS WITHIN THE PROPERTY LIMITS OF THE SCHOOL DISTRICT PROPERTY. THIS REGULATION SHALL BE ENFORCED BY THE CONTRACTOR.
- ALL STAFF, VISITORS, AND ON-SITE LABORERS SHALL WEAR A FACE COVERING WHEN ON SCHOOL PROPERTY.

GRADING NOTES - SITE:

- ALL LAND FORMS SHALL BE GRADED TO BE SMOOTH AND CONTINUOUS SURFACES. CHANGES IN PERCENT OF SLOPE ON SURFACES SHALL BE GRADUAL RATHER THAN ABRUPT. GRADE TRANSITIONAL AREAS TO CREATE VERTICAL CURVES AND ENSURE CONTINUOUS, FLOWING LAND FORM.
- PROVIDE FOR SURFACE DRAINAGE DURING THE PERIOD OF CONSTRUCTION IN A MANNER THAT WILL PROTECT NEWLY GRADED AND ADJACENT AREAS.
- EVERY PRECAUTION AND TEMPORARY MEASURE SHALL BE TAKEN (SUCH AS SILT BARRIERS, TEMPORARY SEEDING, ETC.) TO PREVENT DAMAGE FROM EROSION ON FRESHLY GRADED AREAS. THIS SHALL APPLY TO DAMAGE OF NEWLY GRADED AREAS WITHIN CONSTRUCTION LIMITS AND DAMAGE TO ADJACENT AREA CAUSED BY ERODED MATERIALS. ANY METHODS UTILIZED SHALL MEET AND CONFORM TO ALL LOCAL CODES.
- CONTRACTOR SHALL ENSURE POSITIVE DRAINAGE AWAY FROM ALL EXISTING BUILDINGS.
- ALL VOIDS REMAINING FROM REMOVED ITEMS SHALL BE FILLED AND COMPACTED. GRADE TO PROVIDE CONTINUOUS SURFACES.
- CONTRACTOR SHALL VERIFY THE LOCATION OF ALL UTILITIES PRIOR TO CONSTRUCTION. ANY DAMAGE TO SUCH SHALL BE SOLELY THE RESPONSIBILITY OF THE CONTRACTOR.
- CONTRACTOR SHALL PROTECT ALL EXISTING STRUCTURES AND IMPROVEMENTS TO REMAIN.
- DO NOT DISTURB EXISTING GRADE WITHIN TEN FEET OF EXISTING TREES NOT MARKED FOR REMOVAL.
- ALL SPOT ELEVATIONS ARE TO TOP OF SLAB, TOP OF CURB, OR TOP OF TILE, UNLESS OTHERWISE NOTED.
- FILL AND REGRADE AS REQUIRED TO PROVIDE A SMOOTH TRANSITION FROM NEW TOP OF SLAB TO EXISTING GRADE.
- ANY IRRIGATION COMPONENTS IN THE IMMEDIATE AREAS OF CONSTRUCTION SHALL BE VERIFIED, LOCATED, REMOVED, SALVAGED, REINSTALLED AND ADJUSTED OR REPLACED IF DAMAGED FROM CONSTRUCTION. NEW REPLACEMENT COMPONENTS SHALL BE AT NO ADDITIONAL COST TO THE OWNER AND BE SUBSIDIARY TO THE BID.

LAYOUT & DIMENSION NOTES:

- DO NOT SCALE THESE DRAWINGS UNLESS NOTED. WRITTEN DATA SHALL TAKE PRECEDENCE OVER ANY OTHER DATA.
- CONTRACTOR SHALL PROTECT ALL EXISTING STRUCTURES AND IMPROVEMENTS TO REMAIN.
- ALIGNMENT OF CONCRETE WALKS AND SURFACED PATH SHALL BE FIELD STAKED BY CONTRACTOR, VERIFY WITH LANDSCAPE ARCHITECT PRIOR TO INSTALLATION.
- DIMENSIONS INDICATED WITH A  $\frac{1}{2}$  SHALL BE VERIFIED IN THE FIELD BY THE CONTRACTOR.

GENERAL DEMOLITION NOTES:

- SAFETY BARRICADES AND/OR FENCES SHALL BE PROVIDED AS REQUIRED DURING DEMOLITION OPERATION AND SHALL BE LEFT IN PLACE UNTIL SUFFICIENT REPLACEMENT CONSTRUCTION IS COMPLETE AS DEEMED BY THE OWNER.
- ALL DEMOLITION WORK SHALL BE ACCOMPLISHED IN ACCORD WITH ALL APPLICABLE LOCAL, STATE, AND FEDERAL REQUIREMENTS.
- PRIOR TO DEMOLITION, EROSION CONTROL DEVICES SHALL BE INSTALLED PER LOCAL CODES. EROSION CONTROL DEVICES SHALL BE ADJUSTED AS DEMOLITION AND CONSTRUCTION PROCEEDS AS NECESSARY.
- PROTECT ALL EXISTING FEATURES NOT DESIGNATED FOR REMOVAL. SHOULD REMOVAL AND/OR RELOCATION ACTIVITIES DAMAGE ANY EXISTING FEATURES TO REMAIN, SUCH FEATURES SHALL BE RESTORED TO ORIGINAL CONDITION AT THE EXPENSE OF THE CONTRACTOR. THE CONTRACTOR SHALL NOTIFY THE PROJECT LANDSCAPE ARCHITECT IMMEDIATELY FOR FURTHER INSTRUCTIONS.
- ALL DEMOLISHED AND/OR REMOVED ITEMS SHALL BE HAULED COMPLETELY AWAY FROM THE SITE BY THE CONTRACTOR UNLESS NOTED OTHERWISE.
- ALL MATERIALS SCHEDULED FOR DEMOLITION AND REMOVAL SHALL BE PROMPTLY REMOVED BY THE CONTRACTOR FROM THE SITE. REMOVED MATERIALS SHALL NOT BE MADE AVAILABLE TO ANY DISTRICT EMPLOYEE OR TO THE GENERAL PUBLIC, EXCEPT WHEN SPECIFIED DIRECTLY BY THE DISTRICT PROJECT MANAGER. IF THE CONTRACTOR DECIDES TO SELL OR OTHERWISE CONVEY REMOVED MATERIALS IN THE CONTRACTOR'S POSSESSION TO A DISTRICT EMPLOYEE OR MEMBER OF THE GENERAL PUBLIC, NEITHER THE TRANSACTION NOR THE TRANSFER OF THE MATERIAL SHALL OCCUR ON DISTRICT PROPERTY.
- CONTRACTOR SHALL PROTECT EXISTING OVERHEAD AND UNDERGROUND UTILITIES. ANY DAMAGE TO SUCH UTILITIES SHALL BE REPAIRED BY THE CONTRACTOR AT NO EXPENSE TO THE OWNER.
- ALL TURF AREAS, DISTURBED DURING CONSTRUCTION TO BE SEEDED IN ACCORDANCE WITH SEEDING NOTES AND SPECIFICATIONS.
- ALL PAVEMENT SURFACES DAMAGED DURING CONSTRUCTION SHALL BE REMOVED AND REPLACED TO ORIGINAL ELEVATIONS, AND SHALL BE REPLACED TO THE ORIGINAL CONDITIONS AT THE CONTRACTORS EXPENSE.
- THE CONTRACTOR SHALL PROTECT FINISHED WORK AND SITE AREAS SCHEDULED TO REMAIN INCLUDED IN THIS CONTRACT. DAMAGE TO EXISTING OR IMPROVEMENTS CAUSED BY THE CONTRACTOR OR HIS SUBCONTRACTORS SHALL BE REPAIRED TO THE CONDITION THAT EXISTED PRIOR TO THE START OF CONSTRUCTION ACTIVITY.
- CONDITIONS TO BE REVIEWED WITH OWNER REP AND/OR PHOTOGRAPHED TO IDENTIFY ANY PRE-EXISTING DAMAGE THAT COULD BE MISTAKEN AS CAUSED BY THIS CONTRACTOR PRIOR TO BEGINNING PROJECT.
- IF EXISTING CONDITIONS DIFFER FROM THESE DOCUMENTS, STOP WORK AND NOTIFY OWNERS REP FOR CONSULTATION AS BACKGROUND INFORMATION IS BASED ON DESIGN DOCUMENTS AND NOT AN AS BUILT SURVEY.
- COORDINATE CONSTRUCTION ACTIVITY AS NECESSARY WITH ANY AND ALL REMAINING WORK BEING COMPLETED ON THE OVERALL SCHOOL PROJECT. COMMUNICATE WITH GENERAL CONTRACTOR ON SITE AS NECESSARY.

LOCATION MAP



Sheet Index:

L100 - NOTES AND DEMOLITION NOTES  
L200 - SITE PLAN  
L300 - SITE DETAILS

DEMOLITION LEGEND

- CLEAR AREA EXISTING UNITARY RUBBER TILES AND SUBBASE CONCRETE/AGGREGATE TO NECESSARY SUBGRADE ELEVATION OF POURED IN PLACE SURFACING AND HAUL OFF SITE.
- CLEAR AREA EXISTING UNITARY RUBBER TILES AND SUBBASE CONCRETE/AGGREGATE TO NECESSARY SUBGRADE ELEVATION OF CONCRETE WALK AND HAUL OFF SITE.
- ANTICIPATED ACCESS ROUTE.

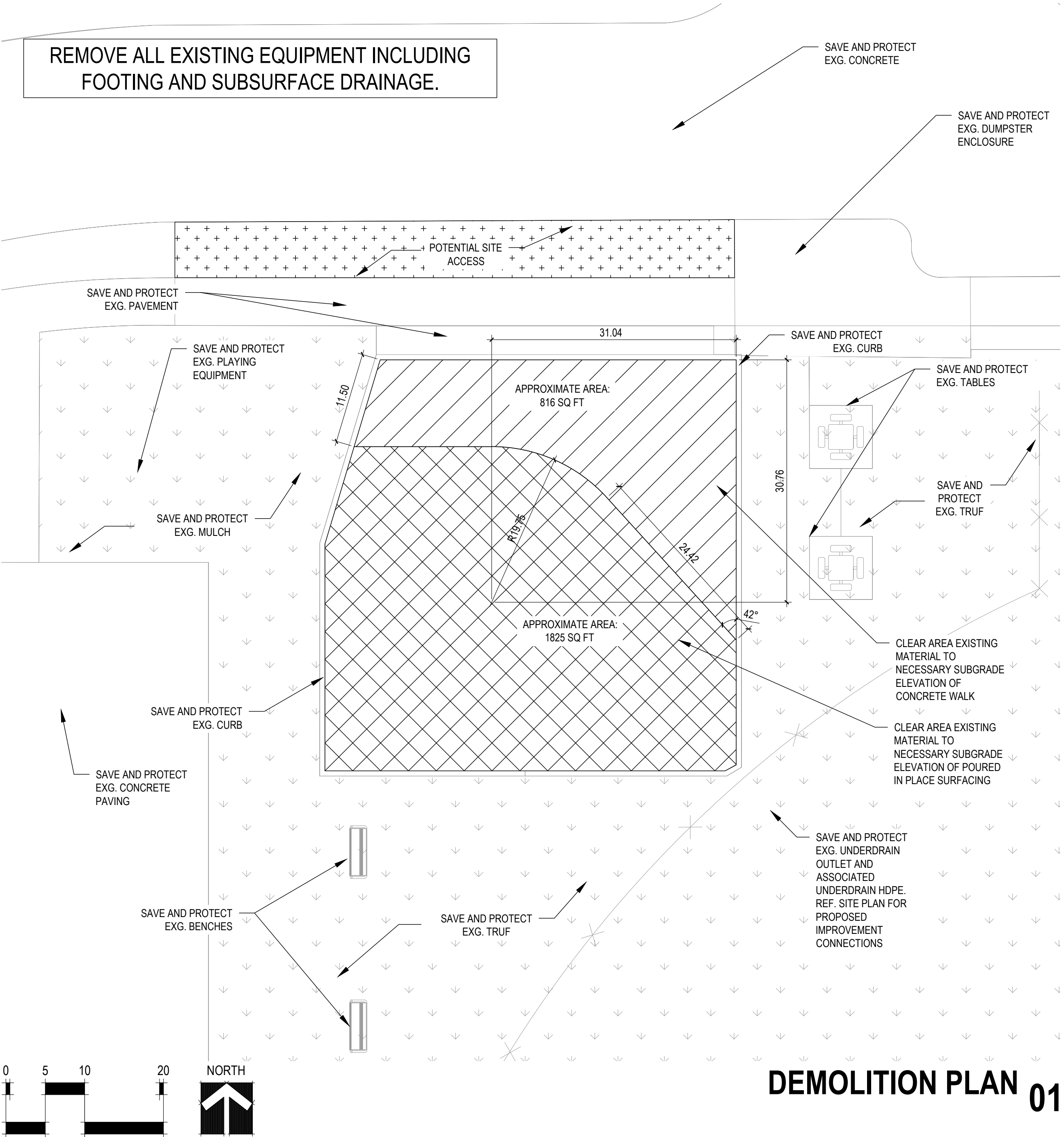

DEMOLITION PLAN 01

PLAYGROUND IMPROVEMENTS

HIGHLAND ELEMENTARY  
2625 JEFFERSON ST  
OMAHA, NE 68107



414 Oak Street, Suite 101  
Kansas City, Missouri 64106  
P 816-756-5690

1111 N. 13th Street, Suite 116  
Omaha, Nebraska 68102  
P 402-533-3465

www.BeVireo.com

Revision Number	Description	Date

03/09/2022  
Date

P-16158.44  
Project Number

SB  
Drawn By

MJH  
Checked By

P-16158.44 - Notes and Demo  
File Name

NOTES AND DEMOLITION NOTES

L100



SITE LEGEND:

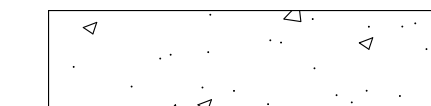

4" CONCRETE WALK. REF SPEC SECTION 32 13 13

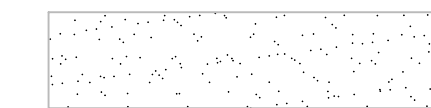

POURED IN PLACE SURFACING. REF SPEC SECTION 31 18 16.



TURF GRASS SEED. REF SPEC SECTION 32 91 00.

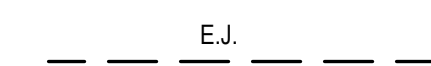

E.J.  
EXPANSION JOINT. REF SPEC SECTION 32 13 13.



CONTROL JOINT. REF SPEC SECTION 32 13 13.

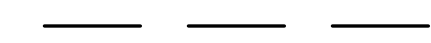

THICKEN EDGE REF DETAIL 01 / L300 - SITE DETAILS.

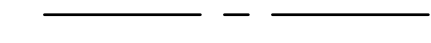

4" HDPE SMOOTH WALL UNDERDRAIN

GRADING NOTES :

1. ALL PROPOSED FINAL SURFACES ELEVATIONS SHALL MATCH EXISTING CONCRETE ELEVATIONS UNLESS OTHERWISE NOTED ON THE PLANS.
2. FINAL SURFACE SLOPES SHALL NOT EXCEED 2% IN ANY DIRECTION.

SITE PLAYGROUND SCHEDULE :

ITEM		QTY.	MANUFACTURER	MODEL	COLOR	REPRESENTATIVE	NOTES
BURKE							
BK-	1	1	BURKE	SY-3194	Owner to select from standadr colors		Inground Mount
BK-	2	1	BURKE	560-2579	Owner to select from standadr colors		Inground Mount
BK-	3	1	BURKE	NU-3139	Owner to select from standadr colors		Inground Mount
BK-	4	1	BURKE	560-2654	Owner to select from standadr colors		Inground Mount

VERIFY USE ZONE DO NOT OVERLAP WITH EXG. OR PROPOSED SITE FEATURES. NOTIFY LANDSCAPE ARCHITECT IF CONFLICTS ARE DISCOVERED.

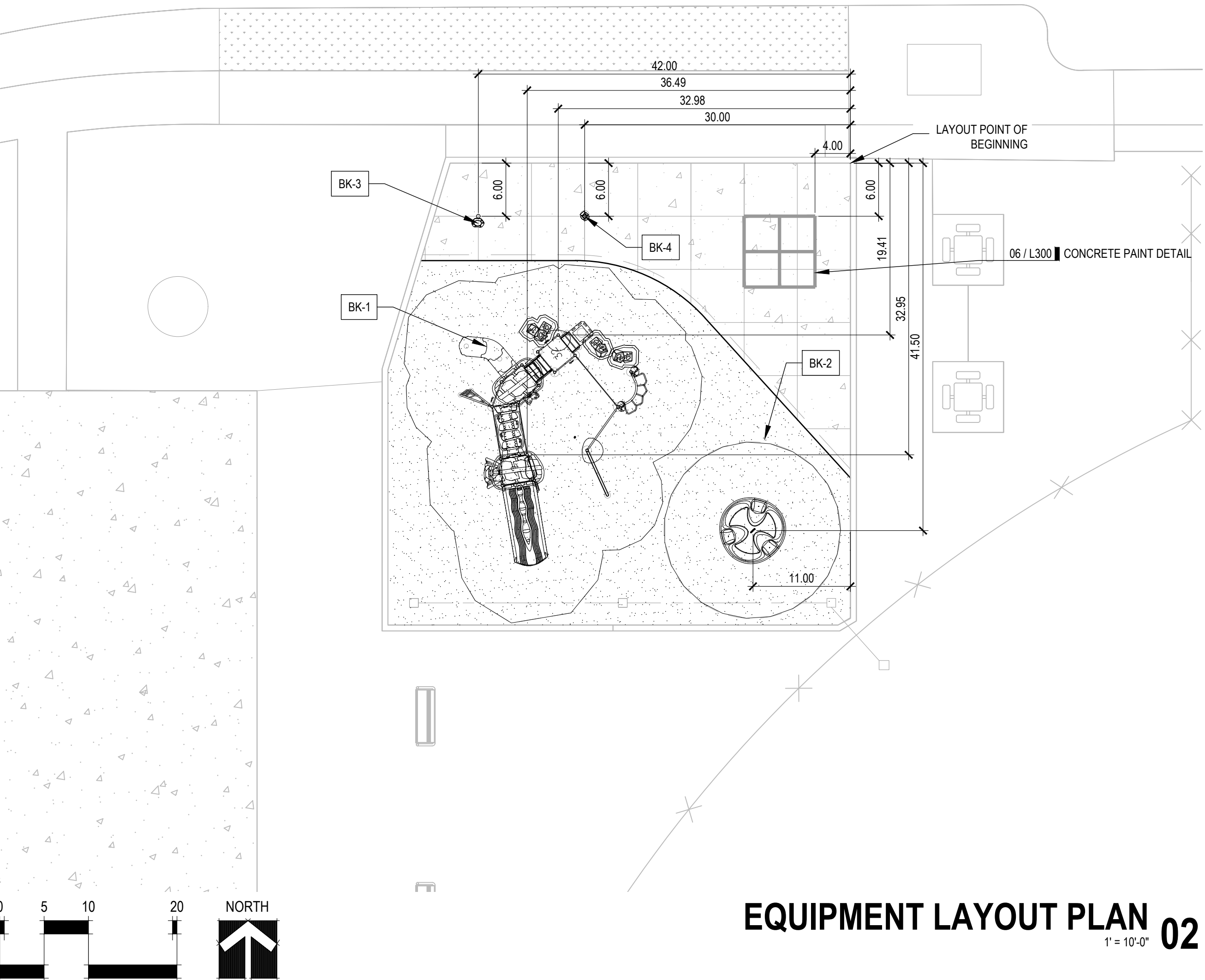
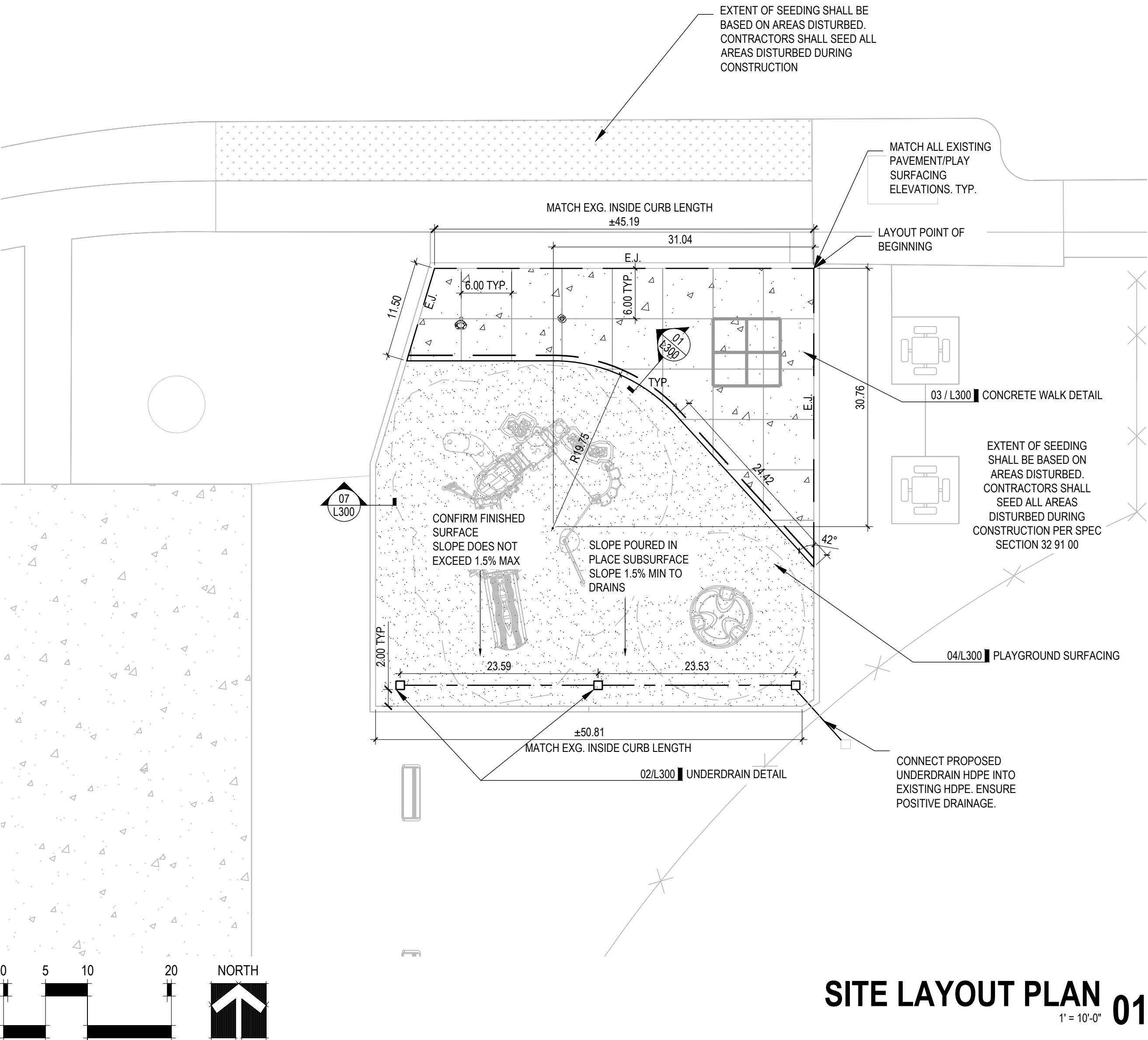

PLAYGROUND IMPROVEMENTS

HIGHLAND ELEMENTARY  
2625 JEFFERSON ST  
OMAHA, NE 68107



414 Oak Street, Suite 101  
Kansas City, Missouri 64106  
P 816-756-5690

1111 N. 13th Street, Suite 116  
Omaha, Nebraska 68102  
P 402-553-9465

www.BeVireo.com

Revision Number	Description	Date

03/09/2022  
Date

P-16158.44  
Project Number

SB  
Drawn By

MJH  
Checked By

P-16158.44 - Site Plan  
File Name

SITE PLAN

PLAYGROUND IMPROVEMENTS

HIGHLAND ELEMENTARY  
2625 JEFFERSON ST  
OMAHA, NE 68107



414 Oak Street, Suite 101  
Kansas City, Missouri 64106  
P 816-756-5690

1111 N. 13th Street, Suite 116  
Omaha, Nebraska 68102  
P 402-553-5465

www.BeVireo.com

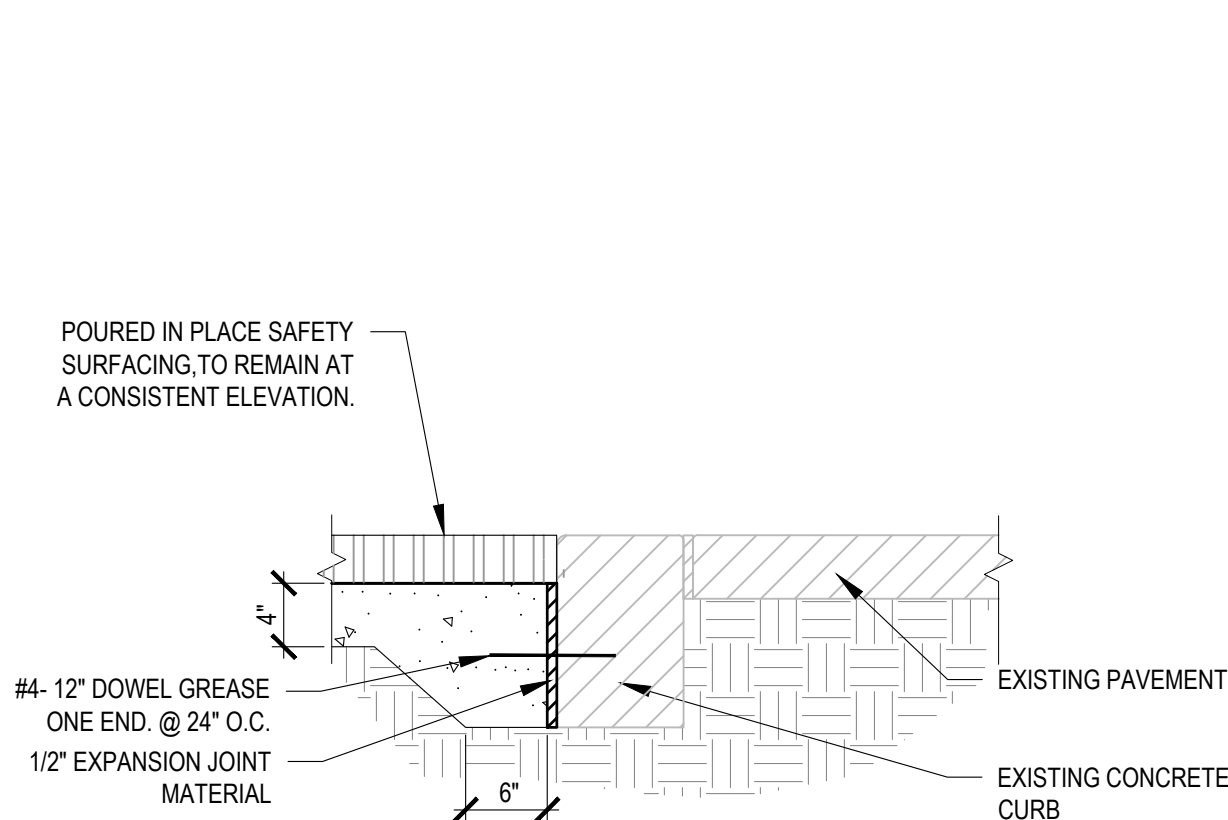

NEW SUBBASE CONCRETE INTO EXG. PLAY CURB 07  
N.T.S.

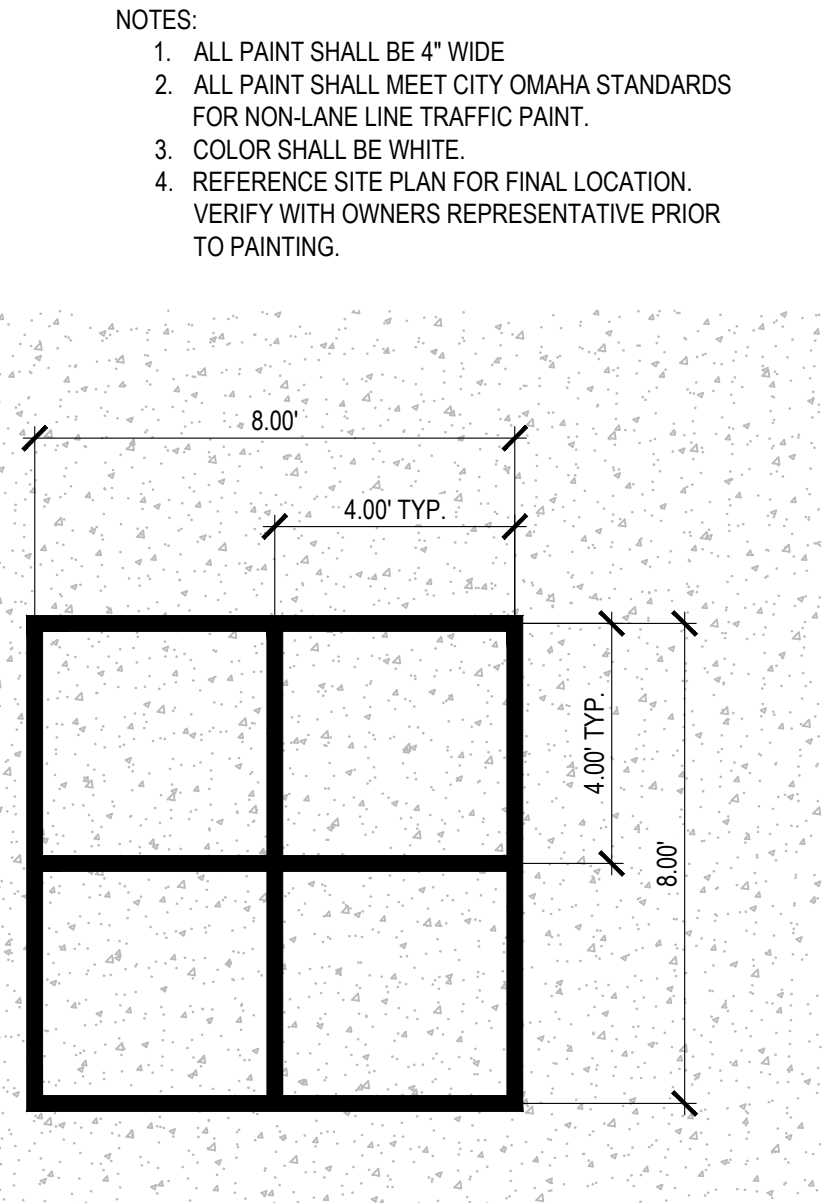

CONCRETE PAINT DETAIL 06  
N.T.S.

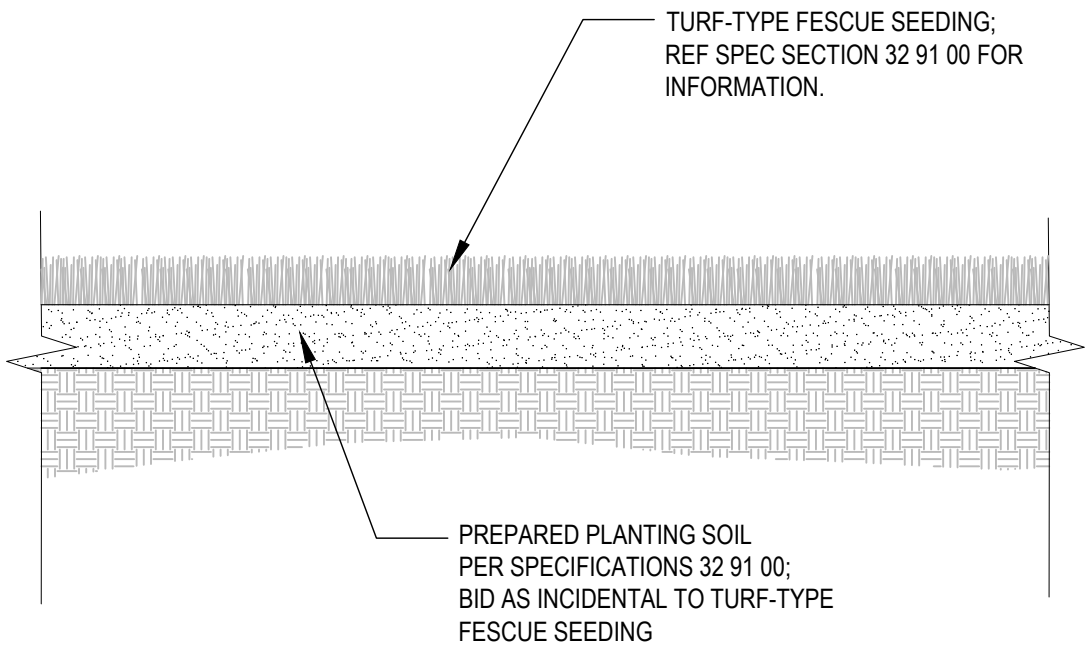

SEEDING DETAIL 05  
N.T.S.

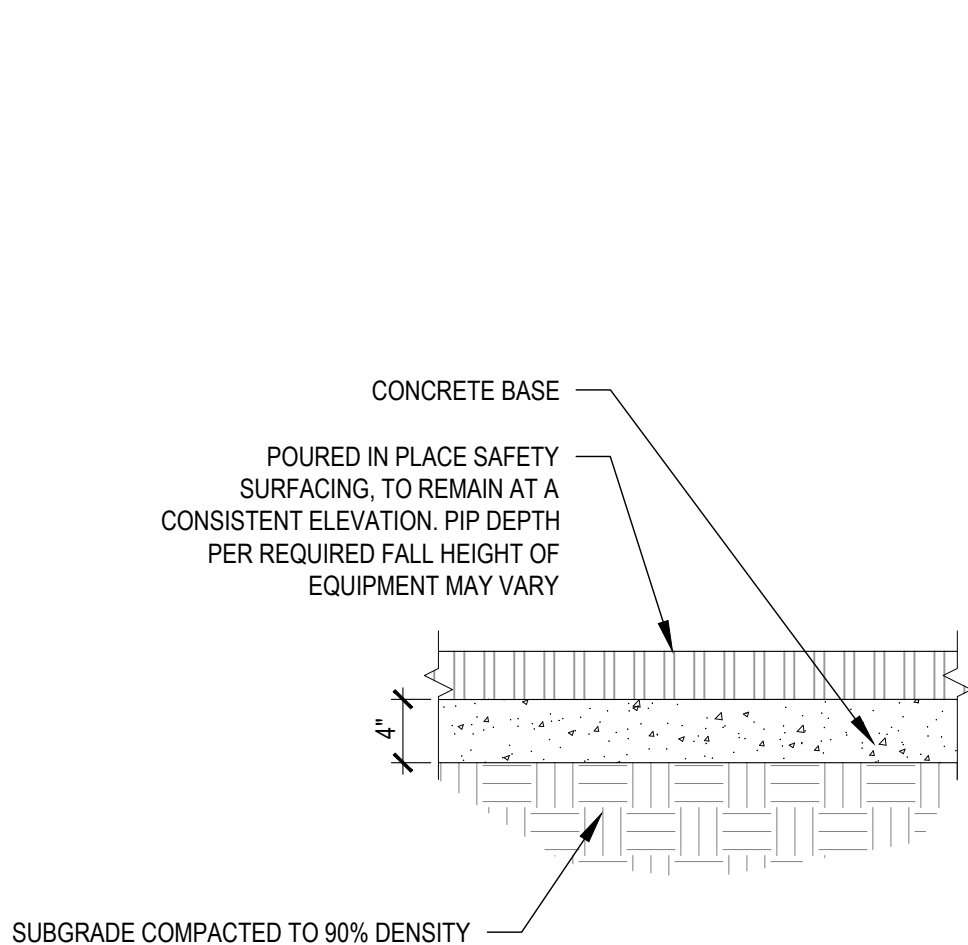

PLAYGROUND SURFACING 04  
N.T.S.

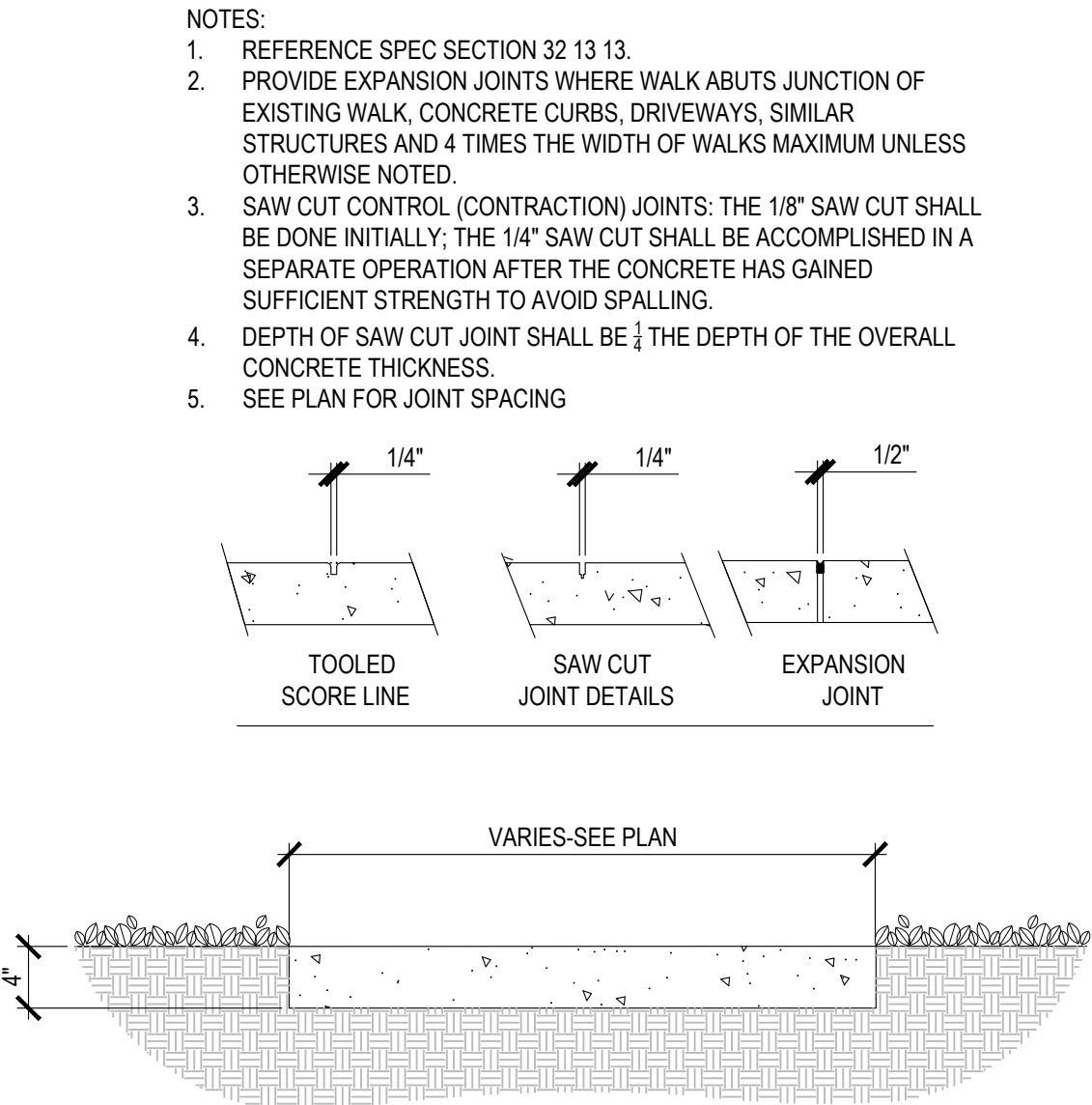

CONCRETE WALK DETAIL 03  
N.T.S.

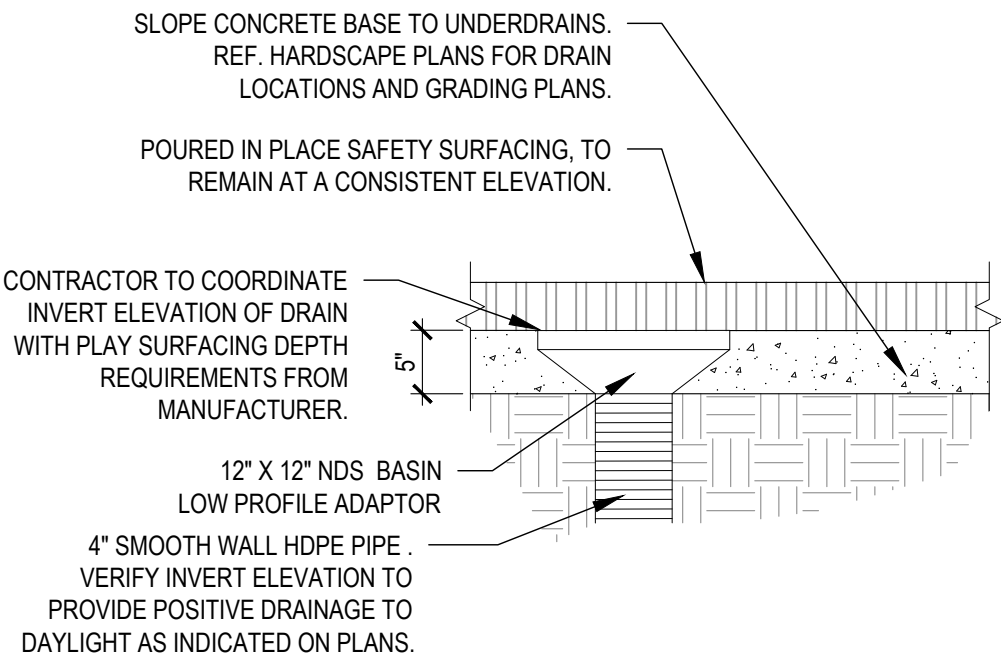

UNDERDRAIN DETAIL 02  
N.T.S.

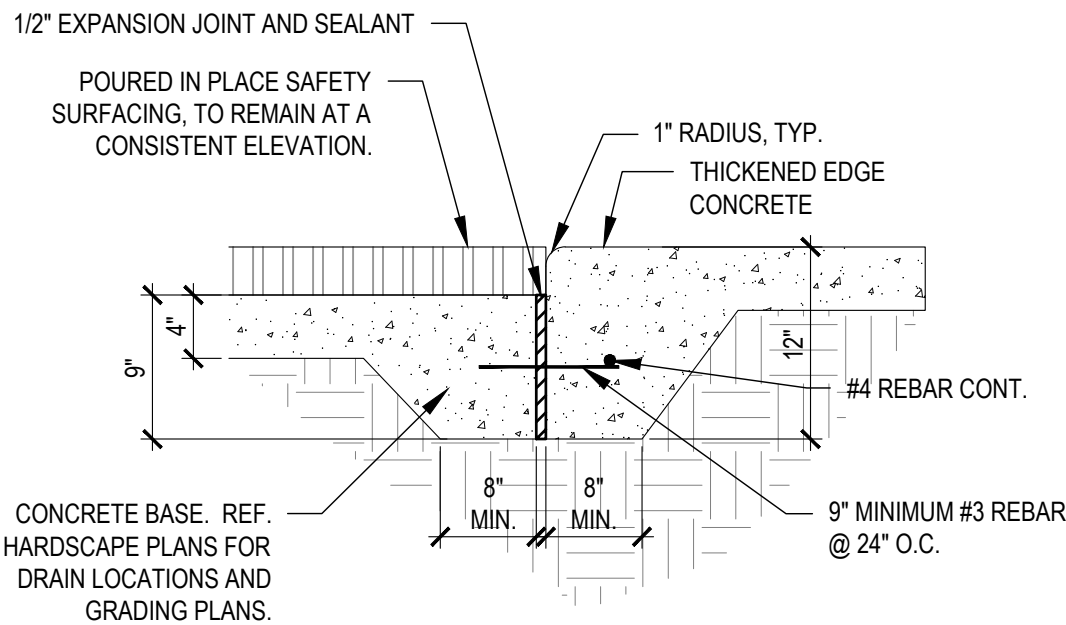

THICKENED EDGE DETAIL 01  
N.T.S.

Revision Number	Description	Date

03/09/2022	P-16158.44
Date	Project Number
SB	MJH
Drawn By	Checked By
P-16158.44 - Site Details	
File Name	

SITE DETAILS